

OPW Loose-Fill Pipe Cap Assemblies

Loose-Fill Pipe Cap Assemblies are installed in spill containment manholes on fill riser pipes from an underground fuel storage tank. They are used when a tight-fill connection is not required.

OPW 83

The OPW 83 Fill Cap Assembly threads onto the fillpipe of an underground or aboveground tank. The screw-on cap is gasketed to ensure a tight seal against air, water, dust and debris. The 83 can be locked with a padlock or wire seal.

Materials

Body: ZA alloy
Cap: Cast iron
Gasket: Nitrile



83 Fill Cap

Ordering Specifications

Product #	Riser Thread		lbs.	kg
	in.	mm		
83-0022	2	51	2.46	1.12

Replacement Parts

Part #	in.	mm	Description
H04898M	2	51	Cap
H01608M	2	51	Gasket

Dimensions

	2" (51mm)	
	in.	mm
A	4 ⁵ / ₈	118
B	2 ⁷ / ₁₆	62
C	2 ¹¹ / ₃₂	60

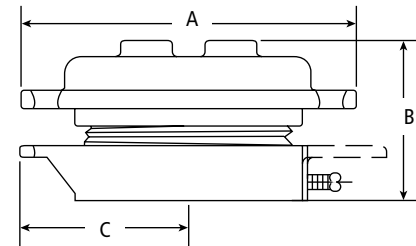

OPW 269 Sanitary Tank Hatch

The OPW 269 Sanitary Tank Hatch threads onto the fill pipe of an underground sanitary waste disposal tank. The 269 is foot-operated and quick-opening/closing for clean emptying of sanitary waste from RVs, campers and travel trailers. The non-recessed design provides straight-through flow to eliminate entrapment of waste materials.

Materials

Body: Coated ductile iron
Cap: Zinc



Ordering Specifications

Product #	Riser Thread		lbs.	kg
	in.	mm		
269-0085	4	102	10.92	4.91

Replacement Parts

Part #	Description
D00800B	Cap
H05783DI	Treadles
H05784M	Pin

