

# DIGITAL INVENTORY & LEAK DETECTION PROBES

INCON® brand digital inventory and leak detection probes provide accurate tank level monitoring and reporting with optional leak detection capabilities. These probes employ digital magnetostrictive position measurement technology for highly accurate tank readings.

## Highlights

- Models available for inventory control or inventory control with leak detection.
- Capable of precise leak detection, density measurement, and inventory monitoring.
- Suitable for use with gasoline, diesel, DEF/AdBlue®, and other manufacturer approved products.
- Bottom mounted installation for fast and simple install.
- Vibration motor integrated into probe head pulses every 5 minutes to reduce the effects of stiction on level reading and leak detection, providing readings with higher accuracy.
- Screw-in electrical connector provides quick installation or removal, eliminating the need to re-splice wires.
- Highly accurate digital communication between the probe and the tank gauge.
- Probes are available in many sizes that are suitable for all common tanks.
- Easily installed into 2", 3" or 4" riser pipes.

## Specifications

- Operating temperature: -40° to 140 °F (-40° to 60 °C)
- Storage temperature: -40° to 158 °F (-40° to 70 °C)
- Non-linearity:  $\pm 0.025\%$  of full scale
- Repeatability:  $\pm 0.001"$
- Temperature sensors: 5 thermistors located in the shaft
- Temperature resolution:  $\pm 0.02$  °F ( $\pm 0.01$  °C)
- Probe pigtail: 10' long three conductor cables with shields and polyurethane jacket
- Compatible with up to three floats for product, water, phase separation detection, or density measurement.
- Compatible with Franklin Fueling Systems tank gauges including: TS-550 evo™, TS-5000 evo™, TS-5, TS-550, TS-5000, Colibri®, TS-1001/2011/750/504/508.

## Approvals/Certifications

- UL & cUL listed, ATEX, IECEx

## Applications

Digital probes feature exceptional linearity, resolution, and stability, and are used in underground and aboveground storage tanks. Two types of probes are available for the following applications:

- The leak detection probes are typically used for underground storage tanks and petroleum applications when static or SCALD leak detection is required.
- The inventory control probes are typically used for aboveground storage tanks, chemical or oil waste, or underground storage tanks that do not require in-tank leak detection.



Inventory & Leak Detection Probe  
(Shown with optional precision density diesel float kit)

Inventory Probe  
(Shown with optional 4" gas float kit)

## Specifications continued

### Components

- 1 Probe head
- 2 Guides
- 3 Bottom mount fitting
- 4 Probe shaft
- 5 Product float
- 6 2" or 4" gas, diesel or phase separation water floats
- 7 Precision or standard density float
- 8 LPG float
- 9 Chemical float

Note: All float kits sold separately.

### Operation

An electromagnetic field is created inside the probe head and forms around a long waveguide within the probe shaft when position measurements are taken. The electromagnetic field interacts with the magnetic field of the float(s) and produces a shock wave in the waveguide that travels at a known speed. When the shock wave is detected at the probe head, the probe creates a signal that corresponds precisely to the product level. Product expansion calculations are enabled by temperature sensors that are located at various points in the probe shaft.

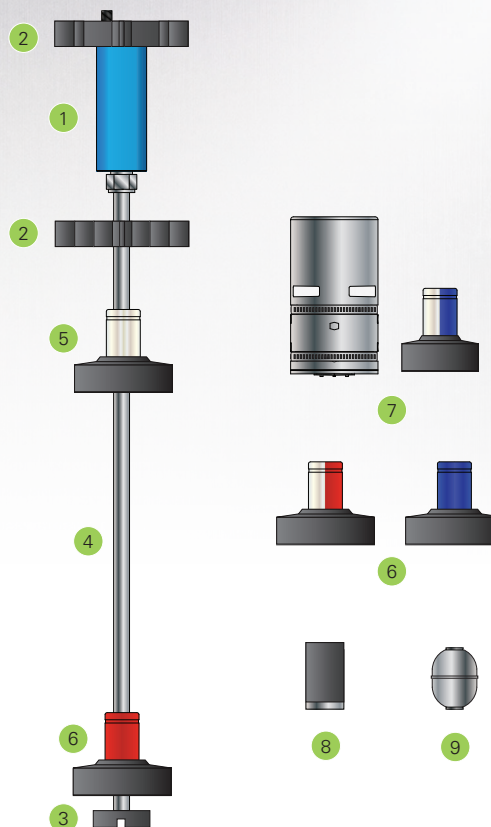

## Ordering Information

### Leak Detection Probes

Model	Description
FMP-LL3-29	2' digital leak detection probe
FMP-LL3-41	3' digital leak detection probe
FMP-LL3-53	4' digital leak detection probe
FMP-LL3-65	5' digital leak detection probe
FMP-LL3-69	5'4" digital leak detection probe
FMP-LL3-77	6' digital leak detection probe
FMP-LL3-81	6'4" digital leak detection probe
FMP-LL3-89	7' digital leak detection probe
FMP-LL3-101	8' digital leak detection probe
FMP-LL3-113	9' digital leak detection probe
FMP-LL3-125	10' digital leak detection probe
FMP-LL3-131	10'6" digital leak detection probe
FMP-LL3-137	11' digital leak detection probe
FMP-LL3-149	12' digital leak detection probe

### Inventory Control Probes

Model	Description
FMP-LL3-29-I	2' digital inventory control probe
FMP-LL3-41-I	3' digital inventory control probe
FMP-LL3-53-I	4' digital inventory control probe
FMP-LL3-65-I	5' digital inventory control probe
FMP-LL3-69-I	5'4" digital inventory control probe
FMP-LL3-77-I	6' digital inventory control probe
FMP-LL3-81-I	6'4" digital inventory control probe
FMP-LL3-89-I	7' digital inventory control probe
FMP-LL3-101-I	8' digital inventory control probe
FMP-LL3-113-I	9' digital inventory control probe
FMP-LL3-125-I	10' digital inventory control probe
FMP-LL3-131-I	10'6" digital inventory control probe
FMP-LL3-137-I	11' digital inventory control probe
FMP-LL3-149-I	12' digital inventory control probe

**INCON**

A Franklin Fueling Systems Brand

franklinfueling.com

3760 Marsh Rd. • Madison, WI 53718, USA

Tel: +1 608 838 8786 • Fax: +1 608 838 6433

Tel: USA & Canada +1 800 225 9787 • Tel: UK +44 (0)1473 243300

Tel: Mex 001 800 738 7610 • Tel: FR +33 (0)1 69 21 41 41 • Tel: CH +86 10 8565 4566